

REV.	ECN NO.	DESCRIPTION	DATE	DESIGN
A				

NOTES:

CURRENT RATING: 2A AC/DC.  
 VOLTAGE RATING: 100V AC/DC  
 TEMPERATURE RANGE: -40°C ~ +105°C.  
 CONTACT RESISTANCE: 0.10MΩMax.  
 INSULATION RESISTANCE: 1000MΩMin.  
 WITHSTANDING VOLTAGE: 800V AC/MINUTE.  
 MATERIAL: PA66 UL94V0.

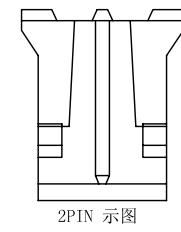
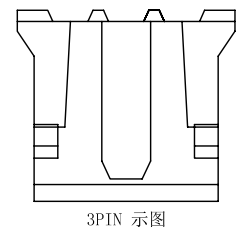
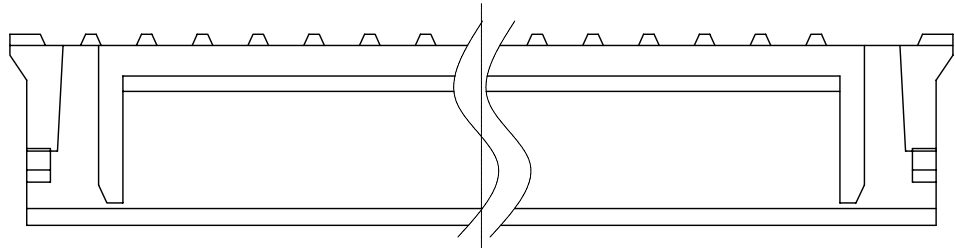
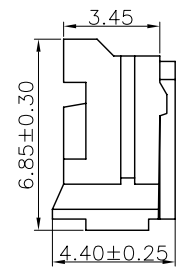
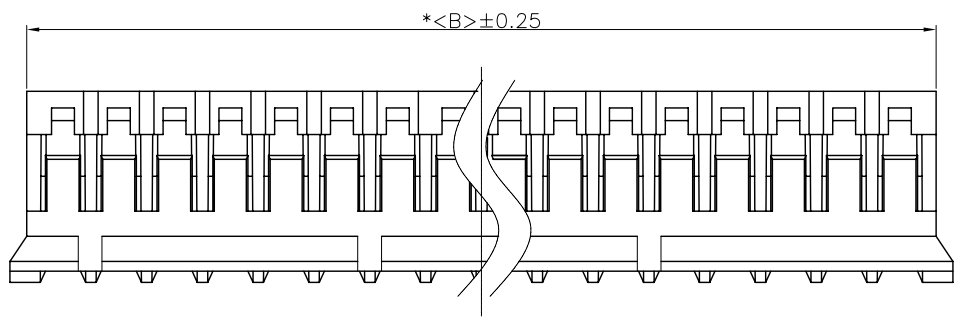
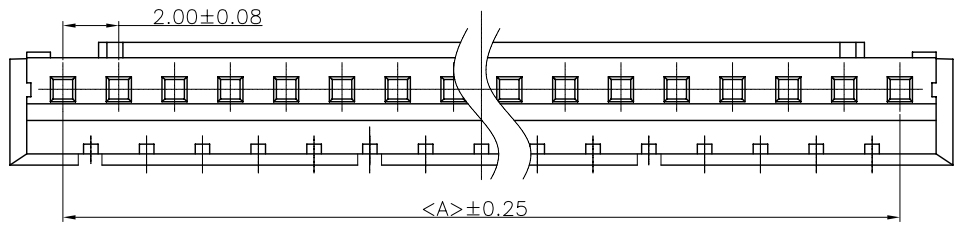

PART NO.	DIMENSIONS	
	A	B
A2001H-02P	2.00	4.60
A2001H-03P	4.00	6.60
A2001H-04P	6.00	8.60
A2001H-05P	8.00	10.60
A2001H-06P	10.00	12.60
A2001H-07P	12.00	14.60
A2001H-08P	14.00	16.60
A2001H-09P	16.00	18.60
A2001H-10P	18.00	20.60
A2001H-11P	20.00	22.60
A2001H-12P	22.00	24.60
A2001H-13P	24.00	26.60
A2001H-14P	26.00	28.60
A2001H-15P	28.00	30.60
A2001H-16P	30.00	32.60

**CNJM** Joint More Precision electronics Co.,Ltd.

DIM	TOL	DIM	TOL	DRAW NO.	DATE	P/N NO:	DRAW NAME:
X.	/	X.	/	DESIGN:	陈雪峰	2017.06.03	A2001H-NP
X.X	0.25	X.X	/	CHECK:	杨 焯		2.0mm pitch housing
X.XX	0.15	X.XX	/	REVIEW:			
X.XXX	0.10	X.XXX	/			REV. A/1	SCALE 1:1
						UNIT: mm	SHEET: 1 OF 1



REV.	ECN NO.	DESCRIPTION	DATE	DESIGN
A				

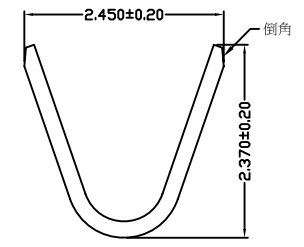
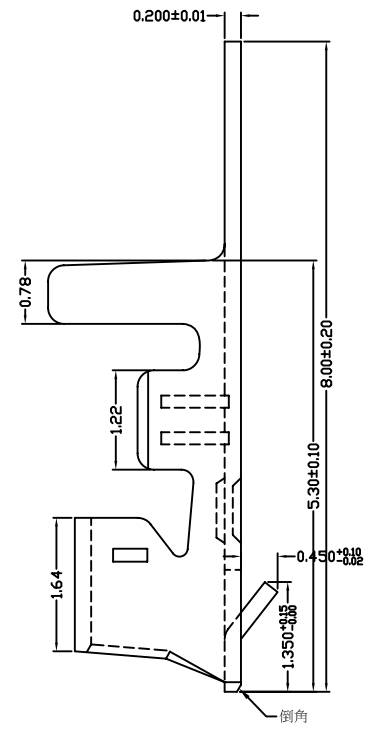
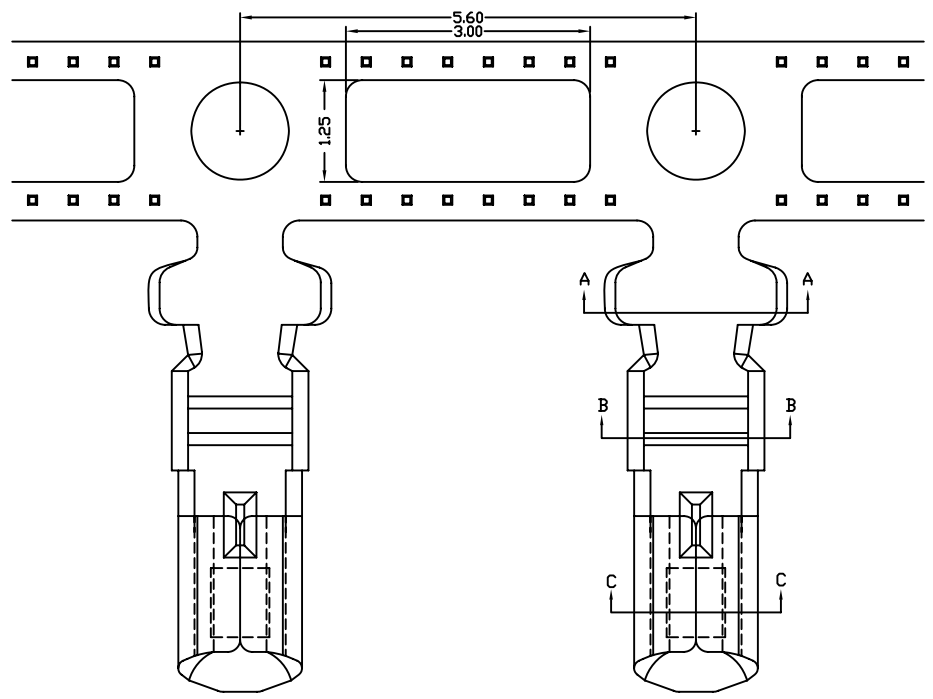

SECTION A-A

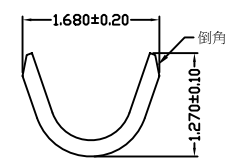

SECTION B-B

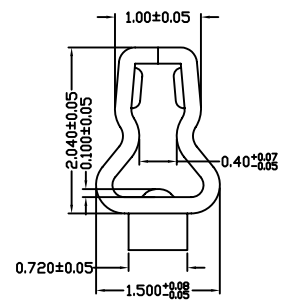

SECTION C-C

**CNJM** Joint More Precision electronics Co.,Ltd.

Part NO.	Wire range	Insulation O.D.	Materials	Finish	Qty/reel
A2001-TP	AWG#24-32	1.8mm(max)	Phosphor Bronze	Tin-plated	10000PCS
A2001-TPE	AWG#24-32	1.8mm(max)	Phosphor Bronze	Tin-plated	10000PCS

DIM	TOL	DIM	TOL
X.	/	X°	/
X.X	0.25	X.X*	
X.XX	0.15	X.XX*	
X.XXX	0.10	X.XXX*	/

DRAW NO.	DATE	P/N NO.	DRAW NAME:
DESIGN: 陈雪峰	2017.06.03	A2001-XXX	2.0mm pitch Terminal
CHECK: 杨焯			
REVIEW:		REV. A/1	SCALE 1:1

UNIT:	SHEET:
mm	1 OF 1



REV.	ECN NO.	DESCRIPTION	DATE	DESIGN

Specifications:  
 Current rating:2A AC/DC.  
 Voltage rating:100V AC/DC  
 Temperature range:-40°C~+105°C.  
 Contact resistance:10MΩ Max.  
 Insulation resistance:1000MΩ Min.  
 Withstanding voltage: 800V AC/minute.  
 Material:PA66.Ul94V-0.

Recommended P.C.B Layout(Top Side)  
 P.C.B Thickness = 1.20mm  
 (Tolerance=±0.05)

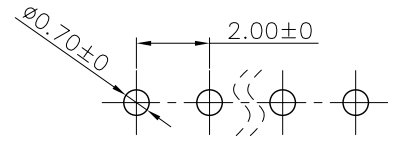
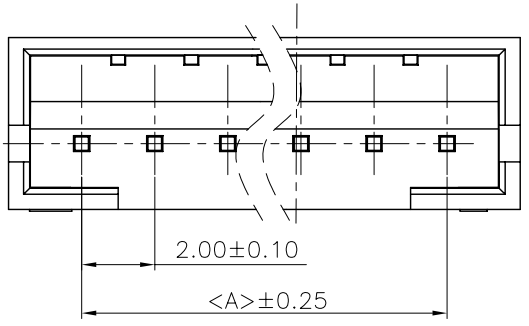

模穴号 1.2.3...

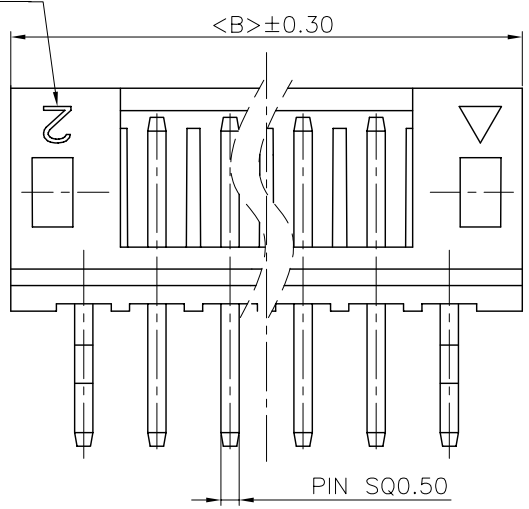

2 PIN 以上图示

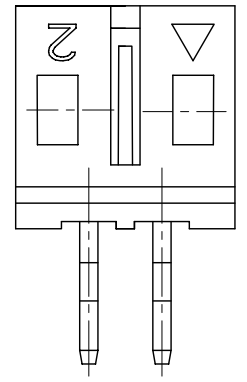

2 PIN 图示

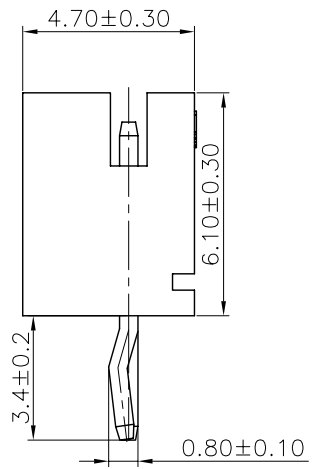

打反“K”

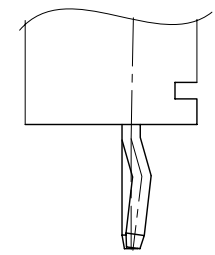

打正“K”

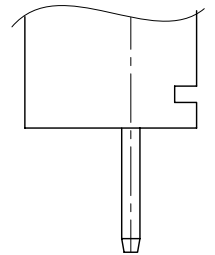

无“K”

PART NO.	Dimensions	
	A	B
A2001WV-02P	2.00	6.00
A2001WV-03P	4.00	8.00
A2001WV-04P	6.00	10.00
A2001WV-05P	8.00	12.00
A2001WV-06P	10.00	14.00
A2001WV-07P	12.00	16.00
A2001WV-08P	14.00	18.00
A2001WV-09P	16.00	20.00
A2001WV-10P	18.00	22.00
A2001WV-11P	20.00	24.00
A2001WV-12P	22.00	26.00
A2001WV-13P	24.00	28.00
A2001WV-14P	26.00	30.00
A2001WV-15P	28.00	32.00
A2001WV-16P	30.00	34.00

**CNJM** Joint More Precision electronics Co.,Led.

DIM	TOL	DIM	TOL	DRAW NO.	DATE	P/N NO:	DRAW NAME:
x.	/	x.	/	DESIGN:	陈雪峰	17/06/03	A2001WV-NP
x.X	±0.25	x.X'	±2'	CHECK:	杨 焯		2.0mm pitch 180° Wafer
x.XX	±0.20	x.XX'	±1'	REVIEW:			
x.XXX	±0.10	x.XXX'	/			REV. A/1	SCALE 1:1
						UNIT: mm	SHEET: 1 OF 1

REV.	ECN NO.	DESCRIPTION	DATE	DESIGN
A				

Specifications:

Current rating:2A AC/DC.  
Voltage rating:100V AC/DC  
Temperature range:-40°C~+105°C.  
Contact resistance:10MΩ Max.  
Insulation resistance:1000MΩ Min.  
Withstanding voltage: 800V AC/minute.  
Material:PA66.UL94V-0.

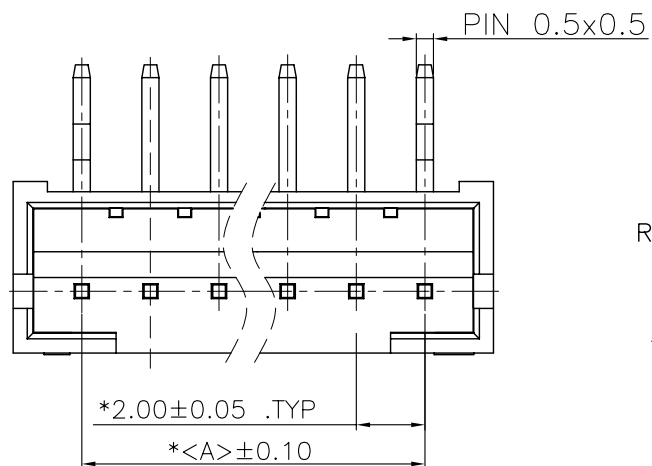

Recommended P.C.B Layout(Top Side)  
P.C.B Thickness = 1.20-1.60mm  
(Tolerance= $\pm 0.05$ )

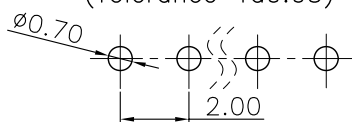

Ordering Information&Dimensions:

PART NO.	Dimensions	
	A	B
A2001WR-02P	2.00	6.00
A2001WR-03P	4.00	8.00
A2001WR-04P	6.00	10.00
A2001WR-05P	8.00	12.00
A2001WR-06P	10.00	14.00
A2001WR-07P	12.00	16.00
A2001WR-08P	14.00	18.00
A2001WR-09P	16.00	20.00
A2001WR-10P	18.00	22.00
A2001WR-11P	20.00	24.00
A2001WR-12P	22.00	26.00
A2001WR-13P	24.00	28.00
A2001WR-14P	26.00	30.00
A2001WR-15P	28.00	32.00
A2001WR-16P	30.00	34.00

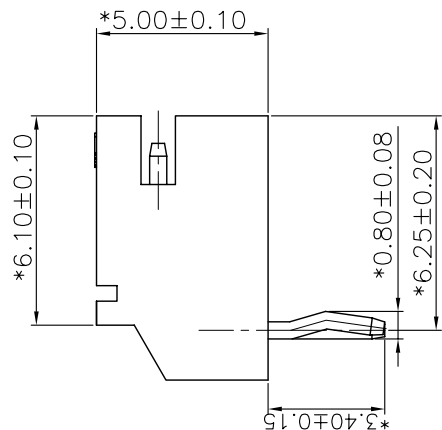
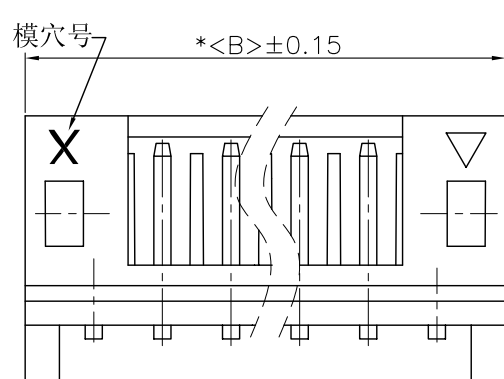

有“K”

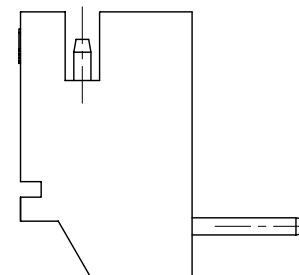

无“K”

**CNJM** Joint More Precision electronics Co.,Ltd.

DRAW NO.	DATE	P/N NO:	DRAW NAME:
DESIGN: 陈雪峰	201706.03	A2001WR-NP	2.0mm pitch 90° wafer
CHECK: 杨焯			
REVIEW:		REV. A/1	SCALE 1:1

DIM	TOL	DIM	TOL
X.	/	X'	/
X.X	0.25	X.X'	/
X.XX	0.15	X.XX'	/
X.XXX	0.10	X.XXX'	/

UNIT: mm SHEET: 1 OF 1

REV.	ECN NO.	DESCRIPTION	DATE	DESIGN
A				

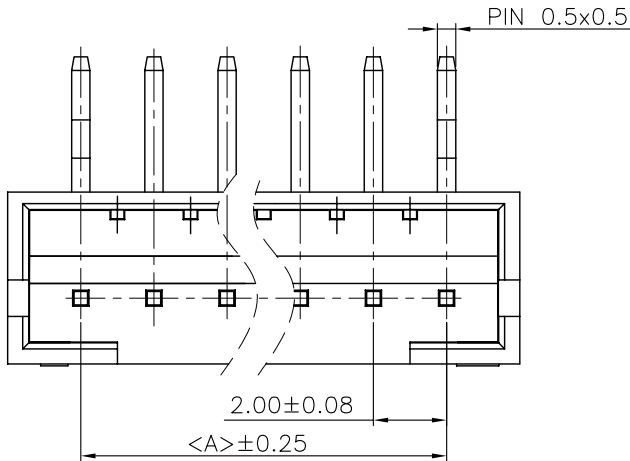

Recommended P.C.B Layout(Top Side)  
P.C.B Thickness = 1.20-1.60mm  
(Tolerance = ±0.05)

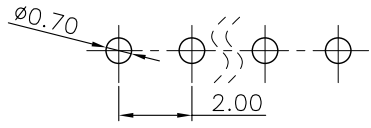

Specifications:  
Current rating: 2A AC/DC.  
Voltage rating: 100V AC/DC  
Temperature range: -40°C ~ +105°C.  
Contact resistance: 10MΩ Max.  
Insulation resistance: 1000MΩ Min.  
Withstanding voltage: 800V AC/minute.  
Material: PA66.UL94V-0.

系列表已全部开发

PART NO.	Dimensions	
	A	B
A2001WVR-02P	2.00	6.00
A2001WVR-03P	4.00	8.00
A2001WVR-04P	6.00	10.00
A2001WVR-05P	8.00	12.00
A2001WVR-06P	10.00	14.00
A2001WVR-07P	12.00	16.00
A2001WVR-08P	14.00	18.00
A2001WVR-09P	16.00	20.00
A2001WVR-10P	18.00	22.00
A2001WVR-11P	20.00	24.00
A2001WVR-12P	22.00	26.00
A2001WVR-13P	24.00	28.00
A2001WVR-14P	26.00	30.00
A2001WVR-15P	28.00	32.00
A2001WVR-16P	30.00	34.00

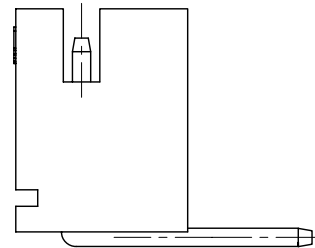
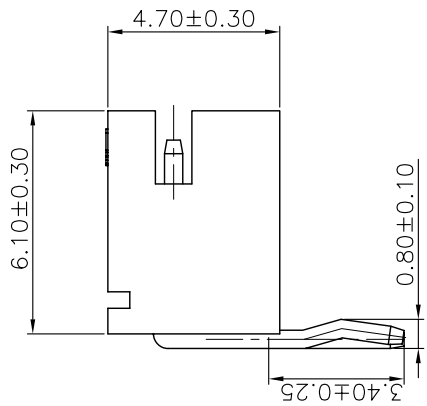
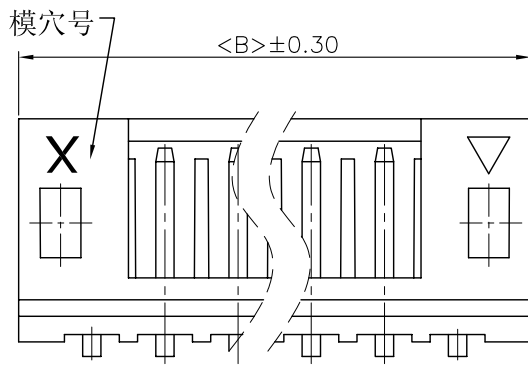

**CNJM** Joint More Precision electronics Co.,Ltd.

DIM	TOL	DIM	TOL
x.	/	x.	/
x.x	0.25	x.x*	/
x.xx	0.20	x.xx*	/
x.xxx	0.10	x.xxx*	/

DRAW NO.	DATE	P/N NO:	DRAW NAME:
DESIGN: 陈雪峰	2017.06.03	A2001WVR-NP	2.0mm pitch wafer平弯
CHECK: 杨焯			
REVIEW:		REV. A/1	SCALE 1:1
		UNIT: mm	SHEET: 1 OF 1